**Dati tecnici - Technical data**

| | |
|--|--|
| Applicazioni - Applications | Circuiti pneumatici, oleodinamici e idraulici Pneumatic and hydraulic systems |
| Pressione di lavoro - Working pressure | 60 bar |
| Depressione - Vacuum | - |
| Range di temperatura - Temperature range | -10 ÷ 70 °C |

Guida alle referenze Guide to references

311 . 01 . - . -

**Serie
Line**

311 = Raccordi tradizionali
Standard fittings

**Modello
Type**

Consultare le tabelle
nelle pagine seguenti
Please check it in the
following pages

**Filetto
Thread
size**

18 = 1/8
14 = 1/4
38 = 3/8
12 = 1/2
M5 = M5

**Filetto
Thread
size**

18 = 1/8
14 = 1/4
38 = 3/8
12 = 1/2
M5 = M5

**Ø Tubo
Tube
diameter**

06 = tubo 6 mm
07 = tubo 7 mm
08 = tubo 8 mm
09 = tubo 6 mm
10 = tubo 10 mm
12 = tubo 12 mm

La linea dei raccordi tradizionali comprende una vasta gamma di prodotti per rispondere alle più svariate esigenze applicative.

The traditional fittings line have a large products range in order to meet the most varied application needs.

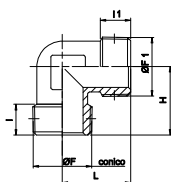
311.01Curva M/M conica
Conical elbow male

| CODICE-CODE | F | F 1 | I | I 1 | H | L | CH | Bag Qty |
|--------------|-----|-----|------|------|------|------|----|---------|
| 311.01.18 | 1/8 | 1/8 | 8 | 8 | 18,5 | 18,5 | 10 | 20 |
| 311.01.14 | 1/4 | 1/4 | 11 | 11 | 23,5 | 23,5 | 13 | 10 |
| 311.01.14.18 | 1/4 | 1/8 | 11 | 8 | 21,5 | 19 | 10 | 20 |
| 311.01.38 | 3/8 | 3/8 | 11,5 | 11,5 | 26 | 26 | 17 | 10 |
| 311.01.12 | 1/2 | 1/2 | 14 | 14 | 31 | 31 | 21 | 5 |

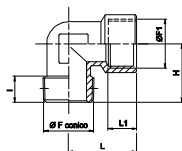
311.02Curva M/F conica
M/F conical elbow

| CODICE-CODE | F | F 1 | I | I 1 | H | L | CH | Bag Qty |
|--------------|-----|-----|------|------|------|------|----|---------|
| 311.02.18 | 1/8 | 1/8 | 8 | 8 | 18,5 | 21 | 10 | 20 |
| 311.02.14 | 1/4 | 1/4 | 11 | 11 | 23,5 | 25,5 | 13 | 10 |
| 311.02.14.18 | 1/4 | 1/8 | 11 | 8 | 21,5 | 21 | 10 | 20 |
| 311.02.38 | 3/8 | 3/8 | 11,5 | 11,5 | 26 | 28 | 17 | 5 |
| 312.01.12 | 1/2 | 1/2 | 14 | 14 | 31 | 33,5 | 21 | 5 |

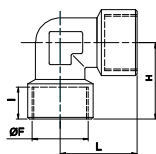
311.03Curva F/F conica
F/F conical elbow

| CODICE-CODE | F | I | H | L | CH | Bag Qty |
|-------------|-----|------|------|------|----|---------|
| 311.03.18 | 1/8 | 8 | 21 | 21 | 10 | 20 |
| 311.03.14 | 1/4 | 11 | 25,5 | 25,5 | 13 | 10 |
| 311.03.38 | 3/8 | 11,5 | 28 | 28 | 17 | 5 |
| 311.03.12 | 1/2 | 14 | 33,5 | 33,5 | 21 | 5 |

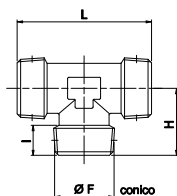
311.04T M/M/M conico
"T" conical male

| CODICE-CODE | F | I | H | L | CH | Bag Qty |
|-------------|-----|------|------|----|----|---------|
| 311.04.18 | 1/8 | 8 | 18,5 | 37 | 10 | 10 |
| 311.04.14 | 1/4 | 11 | 23,5 | 47 | 13 | 5 |
| 311.04.38 | 3/8 | 11,5 | 26 | 52 | 17 | 5 |
| 311.04.12 | 1/2 | 14 | 31 | 62 | 21 | 5 |

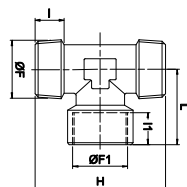
311.05T M/F/M conico
"T" conical M/F/M

| CODICE-CODE | F | F 1 | I | I 1 | H | L | CH | Bag Qty |
|-------------|-----|-----|------|------|----|------|----|---------|
| 311.05.18 | 1/8 | 1/8 | 8 | 8 | 37 | 21 | 10 | 10 |
| 311.05.14 | 1/4 | 1/4 | 11 | 11 | 47 | 25,5 | 13 | 5 |
| 311.05.38 | 3/8 | 3/8 | 11,5 | 11,5 | 52 | 28 | 17 | 5 |
| 311.05.12 | 1/2 | 1/2 | 14 | 14 | 62 | 33,5 | 21 | 5 |

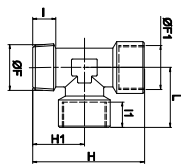
311.06T M/F/F conico
"T" conical M/F/F

| CODICE-CODE | F | F 1 | I | I 1 | H | H1 | L | CH | Bag Qty |
|-------------|-----|-----|------|------|------|------|------|----|---------|
| 311.06.18 | 1/8 | 1/8 | 8 | 8 | 39,5 | 18,5 | 21 | 10 | 10 |
| 311.06.14 | 1/4 | 1/4 | 11 | 11 | 49 | 23,5 | 25,5 | 13 | 5 |
| 311.06.38 | 3/8 | 3/8 | 11,5 | 11,5 | 54 | 26 | 28 | 17 | 5 |
| 311.06.12 | 1/2 | 1/2 | 14 | 14 | 64,5 | 31 | 33,5 | 21 | 5 |

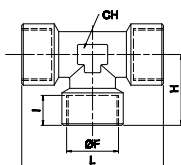
311.07T F/F/F conico
"T" conical female

| CODICE-CODE | F | I | H | L | CH | Bag Qty |
|-------------|-----|------|------|----|----|---------|
| 311.07.18 | 1/8 | 8 | 21 | 42 | 10 | 10 |
| 311.07.14 | 1/4 | 11 | 25,5 | 51 | 13 | 5 |
| 311.07.38 | 3/8 | 11,5 | 28 | 56 | 17 | 5 |
| 311.07.12 | 1/2 | 14 | 33,5 | 67 | 21 | 5 |

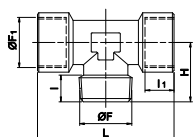
311.08T f/m/f conico
"T" conical F/M/F

| CODICE-CODE | F | F 1 | I | I 1 | H | L | CH | Bag Qty |
|-------------|-----|-----|------|------|------|----|----|---------|
| 311.08.18 | 1/8 | 1/8 | 8 | 8 | 18,5 | 42 | 10 | 10 |
| 311.08.14 | 1/4 | 1/4 | 11 | 11 | 23,5 | 51 | 13 | 5 |
| 311.08.38 | 3/8 | 3/8 | 11,5 | 11,5 | 26 | 56 | 17 | 5 |
| 311.08.12 | 1/2 | 1/2 | 14 | 14 | 31 | 67 | 21 | 5 |

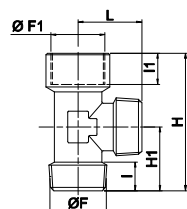
311.09T f/m/m conico
"T" conical F/M/M

| CODICE-CODE | F | F 1 | I | I 1 | H | H1 | L | CH | Bag Qty |
|-------------|-----|-----|------|------|------|------|------|----|---------|
| 311.09.18 | 1/8 | 1/8 | 8 | 8 | 39,5 | 18,5 | 18,5 | 10 | 10 |
| 311.09.14 | 1/4 | 1/4 | 11 | 11 | 49 | 23,5 | 23,5 | 13 | 5 |
| 311.09.38 | 3/8 | 3/8 | 11,5 | 11,5 | 54 | 26 | 26 | 17 | 5 |
| 311.09.12 | 1/2 | 1/2 | 14 | 14 | 64,5 | 31 | 31 | 21 | 5 |

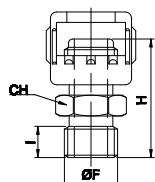
311.36Raccordo dado fresato
Milled fitting nut

| CODICE-CODE | F | I | H | CH | Bag Qty |
|-------------|-----|----|------|----|---------|
| 311.36.14 | 1/4 | 10 | 28,5 | 15 | 2 |

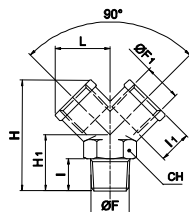
311.10Y F/M/F
"Y" conical F/M/F

| CODICE-CODE | F | F1 | I | I1 | H1 | L | H | CH | Bag Qty |
|-------------|-----|-----|------|------|----|------|------|----|---------|
| 311.10.18 | 1/8 | 1/8 | 8 | 8 | 16 | 14,5 | 32 | 13 | 10 |
| 311.10.14 | 1/4 | 1/4 | 11 | 11 | 20 | 18 | 38 | 17 | 10 |
| 311.10.38 | 3/8 | 3/8 | 11,5 | 11,5 | 22 | 20,5 | 42,5 | 20 | 5 |
| 311.10.12 | 1/2 | 1/2 | 14 | 14 | 27 | 26,5 | 53 | 25 | 5 |

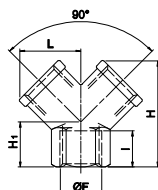
311.11Y F/F/F
"Y" female

| CODICE-CODE | F | I | H1 | L | H1 | CH | Bag Qty |
|-------------|-----|------|----|------|------|----|---------|
| 311.11.18 | 1/8 | 8 | 12 | 14,5 | 26,5 | 13 | 10 |
| 311.11.14 | 1/4 | 11 | 14 | 18 | 32 | 17 | 10 |
| 311.11.38 | 3/8 | 11,5 | 16 | 20,5 | 37 | 20 | 5 |
| 311.11.12 | 1/2 | 14 | 19 | 26,5 | 45 | 25 | 5 |

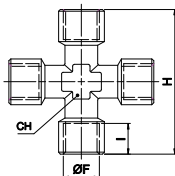
311.13Croce femmina
Female cross

| CODICE-CODE | F | I | H | CH | Bag Qty |
|-------------|-----|------|----|----|---------|
| 311.13.18 | 1/8 | 8 | 42 | 10 | 10 |
| 311.13.14 | 1/4 | 11 | 51 | 13 | 5 |
| 311.13.38 | 3/8 | 11,5 | 56 | 17 | 5 |
| 311.13.12 | 1/2 | 14 | 67 | 21 | 2 |

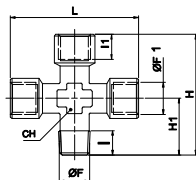
311.12Croce M/F/F/F
M/F/F/F conical cross

| CODICE-CODE | F | F1 | I | I1 | H | H1 | L | CH | Bag Qty |
|-------------|-----|-----|------|------|------|------|----|----|---------|
| 311.12.18 | 1/8 | 1/8 | 8 | 8 | 39,5 | 18,5 | 42 | 10 | 10 |
| 311.12.14 | 1/4 | 1/4 | 11 | 11 | 49 | 23,5 | 51 | 13 | 5 |
| 311.12.38 | 3/8 | 3/8 | 11,5 | 11,5 | 54 | 26 | 56 | 17 | 5 |
| 311.12.12 | 1/2 | 1/2 | 14 | 14 | 64,5 | 31 | 67 | 21 | 2 |

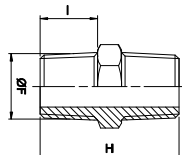
311.14Nipplo M/M conico
Conical male nipple

| CODICE-CODE | F | I | H | CH | Bag Qty |
|-------------|-----|------|------|----|---------|
| 311.14.18 | 1/8 | 8 | 20,5 | 12 | 20 |
| 311.14.14 | 1/4 | 11 | 27 | 14 | 20 |
| 311.14.38 | 3/8 | 11,5 | 28 | 17 | 10 |
| 311.14.12 | 1/2 | 14 | 33,5 | 22 | 5 |
| 311.14.34 | 3/4 | 16,5 | 39,5 | 27 | 5 |
| 311.14.01 | 1" | 19 | 45,5 | 34 | 5 |

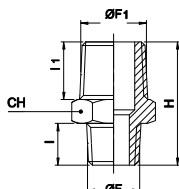
311.16Nippolo M/M conico ridotto
Conical reduction male nipple

| CODICE-CODE | F | F 1 | I | I 1 | H | CH | Bag Qty |
|--------------|-----|-----|------|------|------|----|---------|
| 311.16.18.14 | 1/8 | 1/4 | 8 | 11 | 24 | 14 | 20 |
| 311.16.14.38 | 1/4 | 3/8 | 11 | 11,5 | 27,5 | 17 | 10 |
| 311.16.14.12 | 1/4 | 1/2 | 11 | 14 | 30,5 | 22 | 10 |
| 311.16.38.12 | 3/8 | 1/2 | 11,5 | 14 | 31 | 22 | 10 |
| 311.16.12.34 | 1/2 | 3/4 | 14 | 16,5 | 37 | 27 | 5 |
| 311.16.34.01 | 3/4 | 1" | 16,5 | 19 | 42,5 | 34 | 5 |

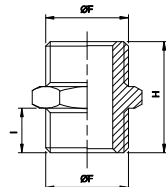
311.15Nippolo M/M cilindrico
Cylindrical male nipple

| CODICE-CODE | F | I | H | CH | Bag Qty |
|-------------|-----|----|------|----|---------|
| 311.15.M5 | M5 | 4 | 11,5 | 8 | 20 |
| 311.15.18 | 1/8 | 6 | 16,5 | 14 | 20 |
| 311.15.14 | 1/4 | 8 | 21 | 17 | 20 |
| 311.15.38 | 3/8 | 9 | 23 | 19 | 10 |
| 311.15.12 | 1/2 | 10 | 25,5 | 24 | 10 |

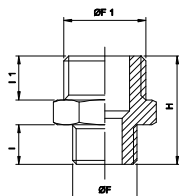
311.17Nippolo M/M cilindrico ridotto
Cylindrical male nipple

| CODICE-CODE | F | F 1 | I | I 1 | H | CH | Bag Qty |
|--------------|-----|-----|----|-----|------|----|---------|
| 311.17.M5.18 | M5 | 1/8 | 4 | 6 | 14,5 | 14 | 20 |
| 311.17.18.14 | 1/8 | 1/4 | 6 | 8 | 19 | 17 | 20 |
| 311.17.18.38 | 1/8 | 3/8 | 6 | 9 | 20 | 19 | 20 |
| 311.17.14.38 | 1/4 | 3/8 | 8 | 9 | 22 | 19 | 10 |
| 311.17.14.12 | 1/4 | 1/2 | 8 | 10 | 23,5 | 24 | 10 |
| 311.17.38.12 | 3/8 | 1/2 | 9 | 10 | 24,5 | 24 | 10 |
| 311.17.12.34 | 1/2 | 3/4 | 10 | 11 | 27,5 | 30 | 5 |
| 311.17.34.01 | 3/4 | 1" | 12 | 11 | 32 | 36 | 5 |

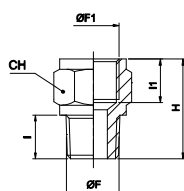
311.18Nippolo M/F conico
M/F conical reducer

| CODICE-CODE | F | F 1 | I | I 1 | H | CH | Bag Qty |
|--------------|-----|-----|------|------|------|----|---------|
| 311.18.18.18 | 1/8 | 1/8 | 8 | 8 | 18 | 14 | 20 |
| 311.18.18.14 | 1/8 | 1/4 | 8 | 11 | 21,5 | 17 | 20 |
| 311.18.14.14 | 1/4 | 1/4 | 11 | 11 | 24,5 | 17 | 10 |
| 311.18.14.38 | 1/4 | 3/8 | 11 | 11,5 | 25,5 | 22 | 10 |
| 311.18.14.12 | 1/4 | 1/2 | 11 | 14 | 29 | 24 | 5 |
| 311.18.38.38 | 3/8 | 3/8 | 11,5 | 11,5 | 26 | 22 | 10 |
| 311.18.38.12 | 3/8 | 1/2 | 11,5 | 14 | 29,5 | 24 | 5 |
| 311.18.12.12 | 1/2 | 1/2 | 14 | 14 | 32 | 26 | 5 |

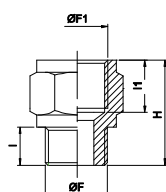
311.19Nippolo M/F cilindrico
M/F cylindrical reducer

| CODICE-CODE | F | F 1 | I | I 1 | H | CH | Bag Qty |
|--------------|-----|-----|----|------|------|----|---------|
| 311.19.18.18 | 1/8 | 1/8 | 6 | 8 | 16 | 14 | 20 |
| 311.19.18.14 | 1/8 | 1/4 | 6 | 11 | 19,5 | 17 | 20 |
| 311.19.14.14 | 1/4 | 1/4 | 8 | 11 | 21,5 | 17 | 20 |
| 311.19.14.38 | 1/4 | 3/8 | 8 | 11,5 | 22,5 | 22 | 20 |
| 311.19.14.12 | 1/4 | 1/2 | 8 | 14 | 26 | 24 | 10 |
| 311.19.38.38 | 3/8 | 3/8 | 9 | 11,5 | 23,5 | 22 | 10 |
| 311.19.38.12 | 3/8 | 1/2 | 9 | 14 | 27 | 24 | 10 |
| 311.19.12.12 | 1/2 | 1/2 | 10 | 14 | 28 | 26 | 5 |

311.20

Colonna M/F
M/F h22 cylindrical extension reducer

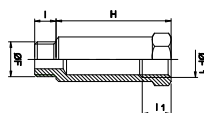

| CODICE-CODE | F | F 1 | I | I 1 | H | L | CH | Bag Qty |
|---------------|-----|-----|---|-----|----|----|----|---------|
| 311.20.18.18 | 1/8 | 1/8 | 6 | 8 | 16 | 22 | 14 | 20 |
| 311.20.18.18 | 1/8 | 1/8 | 6 | 8 | 45 | 51 | 14 | 10 |
| 311.20.14.14 | 1/4 | 1/4 | 8 | 11 | 27 | 35 | 17 | 10 |
| 311.20.14.141 | 1/4 | 1/4 | 8 | 11 | 43 | 51 | 17 | 5 |

311.21

Passaparete M/F
F/F bulkhead

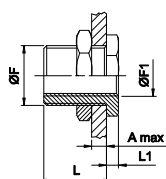

| CODICE-CODE | F | F 1 | A max | L | L 1 | CH | CH 1 | Bag Qty |
|-------------|---------|-----|-------|------|-----|----|------|---------|
| 311.21.M5 | M10X1 | M5 | 7 | 10,5 | 3,5 | 14 | 14 | 10 |
| 311.21.18 | M16X1,5 | 1/8 | 10 | 14 | 4 | 19 | 22 | 10 |
| 311.21.14 | M20X1,5 | 1/4 | 16 | 21 | 4 | 24 | 27 | 5 |
| 311.21.38 | M26X1,5 | 3/8 | 15 | 21 | 5 | 30 | 32 | 5 |
| 311.21.12 | M28X1,5 | 1/2 | 21 | 27 | 6 | 32 | 36 | 5 |

311.22

Riduzione M/F conica
M/F conical reducer

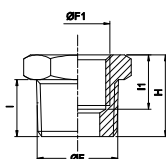

| CODICE-CODE | F | F 1 | I | I 1 | H | CH | Bag Qty |
|--------------|-----|-----|------|------|------|----|---------|
| 311.22.14.18 | 1/4 | 1/8 | 11 | 8 | 16 | 14 | 20 |
| 311.22.38.18 | 3/8 | 1/8 | 11,5 | 8 | 16,5 | 17 | 20 |
| 311.22.38.14 | 3/8 | 1/4 | 11,5 | 11 | 16,5 | 17 | 20 |
| 311.22.12.18 | 1/2 | 1/8 | 14 | 8 | 19,5 | 22 | 10 |
| 311.22.12.14 | 1/2 | 1/4 | 14 | 11 | 19,5 | 22 | 10 |
| 311.22.12.38 | 1/2 | 3/8 | 14 | 11,5 | 19,5 | 22 | 10 |
| 311.22.34.12 | 3/4 | 1/2 | 16,5 | 14 | 23 | 27 | 5 |

311.23

Riduzione M/F cilindrica
M/F cylindrical reducer

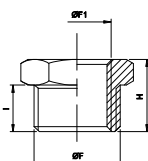

| CODICE-CODE | F | F 1 | I | H | CH | Bag Qty |
|--------------|-----|-----|----|------|----|---------|
| 311.23.18.M5 | 1/8 | M5 | 6 | 10,5 | 14 | 20 |
| 311.23.14.18 | 1/4 | 1/8 | 8 | 13 | 17 | 20 |
| 311.23.38.18 | 3/8 | 1/8 | 9 | 14 | 19 | 20 |
| 311.23.38.14 | 3/8 | 1/4 | 9 | 14 | 19 | 20 |
| 311.23.12.18 | 1/2 | 1/8 | 10 | 15,5 | 24 | 10 |
| 311.23.12.14 | 1/2 | 1/4 | 10 | 15,5 | 24 | 10 |
| 311.23.12.38 | 1/2 | 3/8 | 10 | 15,5 | 24 | 10 |
| 311.23.34.12 | 3/4 | 1/2 | 11 | 17,5 | 30 | 5 |

311.24

Manicotto F/F
F/F sleeve

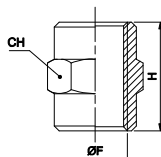

| CODICE-CODE | F | H | CH | Bag Qty |
|-------------|-----|----|----|---------|
| 311.24.M5 | M5 | 11 | 8 | 20 |
| 311.24.18 | 1/8 | 15 | 14 | 20 |
| 311.24.14 | 1/4 | 22 | 17 | 20 |
| 311.24.38 | 3/8 | 23 | 22 | 10 |
| 311.24.12 | 1/2 | 28 | 26 | 10 |
| 311.24.34 | 3/4 | 32 | 32 | 5 |

311.25

Manicotto F/F ridotto
F/F sleeve reducer

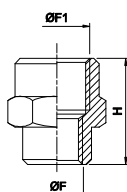

| CODICE-CODE | F | F 1 | H | CH | Bag Qty |
|--------------|-----|-----|------|----|---------|
| 311.25.M5.18 | M5 | 1/8 | 13,5 | 14 | 10 |
| 311.25.18.14 | 1/8 | 1/4 | 19 | 17 | 10 |
| 311.25.18.38 | 1/8 | 3/8 | 20 | 22 | 10 |
| 311.25.14.38 | 1/4 | 3/8 | 22,5 | 22 | 10 |
| 311.25.14.12 | 1/4 | 1/2 | 26 | 24 | 10 |
| 311.25.38.12 | 3/8 | 1/2 | 26 | 24 | 10 |

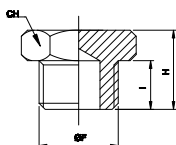
311.26Tappo M esagonale
Male plug

| CODICE-CODE | F | I | H | CH | Bag Qty |
|-------------|-----|----|------|----|---------|
| 311.26.18 | 1/8 | 6 | 10 | 14 | 20 |
| 311.26.14 | 1/4 | 8 | 12,5 | 17 | 20 |
| 311.26.38 | 3/8 | 9 | 13,5 | 19 | 20 |
| 311.26.12 | 1/2 | 10 | 15,5 | 24 | 10 |

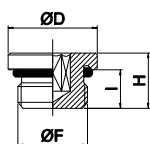
311.28Tappo M cilindrico c/oring
Cylindrical male plug with o-ring

| CODICE-CODE | F | I | H | D | CH | Bag Qty |
|-------------|-----|-----|------|----|----|---------|
| 311.28.18 | 1/8 | 6,5 | 9,5 | 14 | 5 | 20 |
| 311.28.14 | 1/4 | 8 | 11,5 | 17 | 6 | 20 |
| 311.28.38 | 3/8 | 9 | 12,5 | 20 | 8 | 20 |
| 311.28.12 | 1/2 | 10 | 14 | 26 | 10 | 10 |

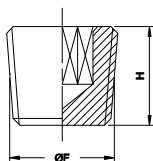
311.29Grano conico in ottone
Conical brass male plug

| CODICE-CODE | F | H | CH | Bag Qty |
|-------------|-----|-----|----|---------|
| 311.29.18 | 1/8 | 7,5 | 5 | 20 |
| 311.29.14 | 1/4 | 10 | 6 | 20 |
| 311.29.38 | 3/8 | 11 | 8 | 20 |
| 311.29.12 | 1/2 | 13 | 10 | 10 |

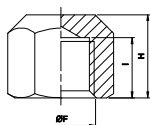
311.30Tappo femmina
Plug female

| CODICE-CODE | F | I | H | CH | Bag Qty |
|-------------|-----|------|------|----|---------|
| 311.30.18 | 1/8 | 8 | 11,5 | 14 | 20 |
| 311.30.14 | 1/4 | 11 | 15 | 17 | 20 |
| 311.30.38 | 3/8 | 11,5 | 15,5 | 20 | 10 |
| 311.30.12 | 1/2 | 14 | 20 | 24 | 10 |

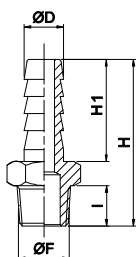
311.31Portagomma maschio conico
Conical male hose

| CODICE-CODE | D | F | I | H | H 1 | CH | Bag Qty |
|--------------|----|-----|------|------|-----|----|---------|
| 311.31.06.18 | 6 | 1/8 | 8 | 31,5 | 19 | 12 | 20 |
| 311.31.06.14 | 6 | 1/4 | 11 | 35 | 19 | 14 | 20 |
| 311.31.07.18 | 7 | 1/8 | 8 | 31,5 | 19 | 12 | 20 |
| 311.31.07.14 | 7 | 1/4 | 11 | 35 | 19 | 14 | 20 |
| 311.31.08.18 | 8 | 1/8 | 8 | 31,5 | 19 | 12 | 20 |
| 311.31.08.14 | 8 | 1/4 | 11 | 35 | 19 | 14 | 20 |
| 311.31.09.18 | 9 | 1/8 | 8 | 31,5 | 19 | 12 | 20 |
| 311.31.09.14 | 9 | 1/4 | 11 | 35 | 19 | 14 | 20 |
| 311.31.09.38 | 9 | 3/8 | 11,5 | 35,5 | 19 | 17 | 20 |
| 311.31.09.12 | 9 | 1/2 | 14 | 38,5 | 19 | 22 | 10 |
| 311.31.10.14 | 10 | 1/4 | 11 | 36 | 20 | 14 | 20 |
| 311.31.10.38 | 10 | 3/8 | 11,5 | 36,5 | 20 | 17 | 20 |
| 311.31.10.12 | 10 | 1/2 | 14 | 39,5 | 20 | 22 | 20 |
| 311.31.12.38 | 12 | 3/8 | 11,5 | 36,5 | 20 | 17 | 10 |
| 311.31.12.12 | 12 | 1/2 | 14 | 39,5 | 20 | 22 | 10 |

311.32

Portagomma maschio cilindrico c/oring
Cylindrical male hose with o-ring

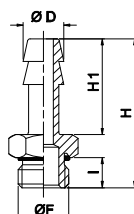

| CODICE-CODE | D | F | I | H | H 1 | CH | Bag Qty |
|--------------|----|-----|-----|------|-----|----|---------|
| 311.32.06.18 | 6 | 1/8 | 6,5 | 30 | 19 | 14 | 20 |
| 311.32.06.14 | 6 | 1/4 | 8 | 32 | 19 | 17 | 20 |
| 311.32.07.18 | 7 | 1/8 | 6,5 | 30 | 19 | 14 | 20 |
| 311.32.07.14 | 7 | 1/4 | 8 | 32 | 19 | 17 | 20 |
| 311.32.08.18 | 8 | 1/8 | 6,5 | 30 | 19 | 14 | 20 |
| 311.32.08.14 | 8 | 1/4 | 8 | 32 | 19 | 17 | 20 |
| 311.32.09.18 | 9 | 1/8 | 6,5 | 30 | 19 | 14 | 20 |
| 311.32.09.14 | 9 | 1/4 | 8 | 32 | 19 | 17 | 20 |
| 311.32.09.38 | 9 | 3/8 | 9 | 33 | 19 | 20 | 20 |
| 311.32.12.14 | 12 | 1/4 | 8 | 33 | 20 | 17 | 10 |
| 311.32.12.38 | 12 | 3/8 | 9 | 34 | 20 | 20 | 10 |
| 311.32.12.12 | 12 | 1/2 | 10 | 35,5 | 20 | 24 | 10 |

311.33

Portagomma cilindrico
Cylindrical male hose

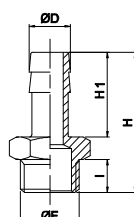

| CODICE-CODE | D | F | I | H | H 1 | CH | Bag Qty |
|--------------|----|-----|----|------|-----|----|---------|
| 311.33.06.18 | 6 | 1/8 | 6 | 29,5 | 19 | 12 | 20 |
| 311.33.06.14 | 6 | 1/4 | 8 | 32 | 19 | 14 | 20 |
| 311.33.07.18 | 7 | 1/8 | 6 | 29,5 | 19 | 12 | 20 |
| 311.33.07.14 | 7 | 1/4 | 8 | 32 | 19 | 14 | 20 |
| 311.33.08.18 | 8 | 1/8 | 6 | 29,5 | 19 | 12 | 20 |
| 311.33.08.14 | 8 | 1/4 | 8 | 32 | 19 | 14 | 20 |
| 311.33.08.38 | 8 | 3/8 | 9 | 33 | 19 | 19 | 20 |
| 311.33.09.14 | 9 | 1/4 | 8 | 32 | 19 | 14 | 20 |
| 311.33.09.38 | 9 | 3/8 | 9 | 33 | 19 | 19 | 20 |
| 311.33.10.14 | 10 | 1/4 | 8 | 33 | 20 | 14 | 20 |
| 311.33.10.38 | 10 | 3/8 | 9 | 34 | 20 | 19 | 20 |
| 311.33.12.14 | 12 | 1/4 | 8 | 33 | 20 | 14 | 20 |
| 311.33.12.38 | 12 | 3/8 | 9 | 34 | 20 | 19 | 10 |
| 311.33.12.12 | 12 | 1/2 | 10 | 35,5 | 20 | 22 | 10 |

311.34

Partitore a 4 vie
Cross manifold

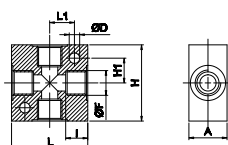
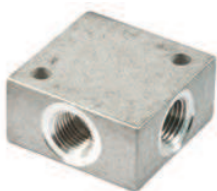

| CODICE-CODE | F | I | H | H 1 | L | L 1 | D | A | Bag Qty |
|-------------|-----|------|----|-----|----|-----|-----|----|---------|
| 311.34.18 | 1/8 | 8 | 25 | 8,5 | 25 | 8,5 | 4,5 | 16 | 10 |
| 311.34.14 | 1/4 | 11 | 40 | 13 | 40 | 13 | 5,5 | 20 | 5 |
| 311.34.38 | 3/8 | 11,5 | 50 | 17 | 50 | 17 | 5,5 | 25 | 2 |
| 311.34.12 | 1/2 | 14 | 50 | 17 | 50 | 17 | 5,5 | 30 | 2 |

311.35

Partitore multiplo uscite 1 lato
Multiple out-put 1 side manifold

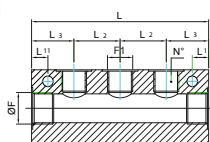

| CODICE-CODE | F | F 1 | A | H | L 1 | L 2 | L 3 | L | N° | Bag Qty |
|--------------|-----|-----|----|----|-----|-----|-----|-----|----|---------|
| 311.35.14.02 | 1/4 | 1/8 | 20 | 30 | 4,5 | 18 | 18 | 54 | 2 | 2 |
| 311.35.14.03 | 1/4 | 1/8 | 20 | 30 | 4,5 | 18 | 18 | 72 | 3 | 2 |
| 311.35.14.04 | 1/4 | 1/8 | 20 | 30 | 4,5 | 18 | 18 | 90 | 4 | 2 |
| 311.35.14.05 | 1/4 | 1/8 | 20 | 30 | 4,5 | 18 | 18 | 108 | 5 | 2 |
| 311.35.38.02 | 3/8 | 1/4 | 25 | 40 | 8,5 | 24 | 22 | 68 | 2 | 2 |
| 311.35.38.03 | 3/8 | 1/4 | 25 | 40 | 8,5 | 24 | 22 | 92 | 3 | 2 |
| 311.35.38.04 | 3/8 | 1/4 | 25 | 40 | 8,5 | 24 | 22 | 116 | 4 | 2 |
| 311.35.38.05 | 3/8 | 1/4 | 25 | 40 | 8,5 | 24 | 22 | 140 | 5 | 2 |

311.36

Partitore multiplo uscite 2 lati
Multiple out-put 2 side manifold

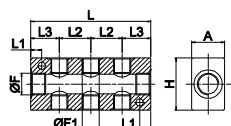

| CODICE-CODE | F | F 1 | A | H | L 1 | L 2 | L 3 | L | N° | Bag Qty |
|--------------|-----|-----|----|----|-----|-----|-----|-----|-----|---------|
| 311.36.14.02 | 1/4 | 1/8 | 20 | 30 | 4,5 | 18 | 18 | 54 | 2+2 | 2 |
| 311.36.14.03 | 1/4 | 1/8 | 20 | 30 | 4,5 | 18 | 18 | 72 | 3+3 | 2 |
| 311.36.14.04 | 1/4 | 1/8 | 20 | 30 | 4,5 | 18 | 18 | 90 | 4+4 | 2 |
| 311.36.14.05 | 1/4 | 1/8 | 20 | 30 | 4,5 | 18 | 18 | 108 | 5+5 | 2 |
| 311.36.38.02 | 3/8 | 1/4 | 25 | 40 | 8,5 | 24 | 22 | 68 | 2+2 | 2 |
| 311.36.38.03 | 3/8 | 1/4 | 25 | 40 | 8,5 | 24 | 22 | 92 | 3+3 | 2 |
| 311.36.38.04 | 3/8 | 1/4 | 25 | 40 | 8,5 | 24 | 22 | 116 | 4+4 | 2 |
| 311.36.38.05 | 3/8 | 1/4 | 25 | 40 | 8,5 | 24 | 22 | 140 | 5+5 | 2 |

311.38.01

Innesto rapido maschio serie "Italia"
Male quick coupling "Italy" series

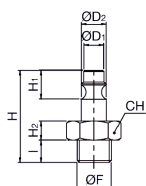

| CODICE-CODE | F | I | H | H1 | H2 | D1 | D2 | CH |
|--------------|-----|---|----|----|----|-----|----|----|
| 311.38.01.14 | 1/4 | 8 | 37 | 14 | 5 | 7,5 | 12 | 14 |
| 311.38.01.38 | 3/8 | 8 | 37 | 14 | 5 | 7,5 | 12 | 17 |

311.38.02

Rubinetto rapido a sfera serie "Italia"
Thread quick coupling "Italy" series

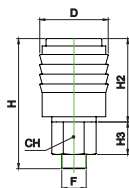

| CODICE-CODE | F | H | H1 | H2 | D | CH |
|--------------|-----|----|----|----|------|----|
| 311.38.02.14 | 1/4 | 51 | 25 | 13 | 22,7 | 15 |
| 311.38.02.38 | 3/8 | 45 | 25 | 5 | 22,7 | 17 |
| 311.38.02.12 | 1/2 | 47 | 25 | 7 | 22,7 | 21 |

311.38.03

Rubinetto rapido a sfera spirale serie "Italia"
Spring quick coupling "Italy" series

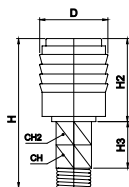

| CODICE-CODE | F | H | H1 | H2 | D | CH | CH1 |
|--------------|-------|-----|----|------|------|----|-----|
| 311.38.03.08 | 8x6 | 138 | 25 | 23,5 | 22,7 | 15 | 13 |
| 311.38.03.10 | 10x8 | 138 | 25 | 23,5 | 22,7 | 15 | 15 |
| 311.38.03.12 | 12x10 | 140 | 25 | 23,5 | 22,7 | 15 | 17 |